

C₁ FOR 400HP/350HP - 2 POLES (NOTE 6)

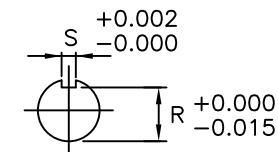
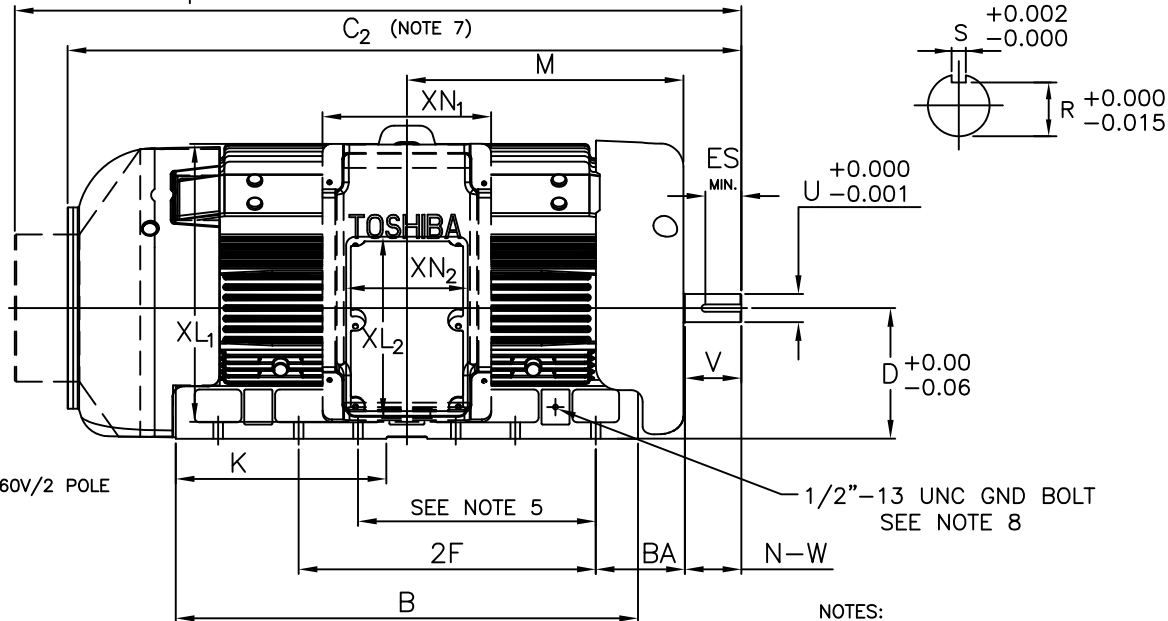

UNITS: INCHES

| FRAME SIZE | MOTOR DIMENSIONS | | | | | | | | | | | |
|---------------|------------------|------|----------------|----------------|-------|-----|-----|------|------|------|------|-----|
| | A | B | C ₁ | C ₂ | D | G | J | K | M | O | P | T |
| B447TS/B449TS | 22.0 | 38.9 | 61.1 | 56.7 | 11.00 | 1.4 | 4.5 | 17.7 | 23.3 | 25.1 | 27.9 | 1.3 |

| FRAME SIZE | CONDUIT BOX | | | | | | | | | | | |
|---------------|-------------|-----------------|-----------------|-----------------|-----------------|-------|-----------------|-----------------|-----------------|-----------------|-----------------|-----------------|
| | AA[NPT] | AB ₁ | AB ₂ | AC ₁ | AC ₂ | AE | AF ₁ | AF ₂ | XL ₁ | XL ₂ | XN ₁ | XN ₂ |
| B447TS/B449TS | 4.00 | 29.8 | 23.8 | 22.4 | 19.6 | 11.00 | 9.6 | 9.1 | 23.4 | 15.2 | 14.2 | 10.2 |

| FRAME SIZE | MOUNTING | | | | SHAFT EXTENSION | | | KEY SEAT | | | BEARINGS | | MAXIMUM WEIGHT |
|---------------|----------|-------------|------|------|-----------------|------|-------|----------|-------|------|----------|--------|----------------|
| | E | 2F | H | BA | N-W | V | U | R | S | ES | LS | OS | |
| B447TS/B449TS | 9.00 | 20.00/25.00 | 0.81 | 7.50 | 4.75 | 4.50 | 2.375 | 2.021 | 0.625 | 3.03 | 6313C3 | 6313C3 | 4000 lbs. |

NOTES:

- DIMENSION V REPRESENTS LENGTH OF STRAIGHT PART OF SHAFT
- MAIN CONDUIT BOX MAY BE ROTATED IN 90° INCREMENTS
- KEY DIMENSIONS EQUAL S x S x 3.00 (MOTOR SUPPLIED WITH KEY).
- MOTOR WEIGHT SHOWN IS MAXIMUM HORSEPOWER IN FRAME.
- THIS DIMENSION EQUALS 2F FOR B447T MOUNTING.
- 400HP/350HP 2 POLE STANDARD PRODUCT USE UNI-DIRECTIONAL FAN. OPPOSITE ROTATION AVAILABLE ONLY BY FAN AND CONNECTION CHANGE.
- 300HP/250HP 2 POLE STANDARD PRODUCT USE BI-DIRECTIONAL FAN. OPPOSITE ROTATION AVAILABLE BY CONNECTION CHANGE.
- FRAME GROUND BOLT STANDARD ON 841 PRODUCT.

CUSTOMER: _____ MOTOR MODEL NO.: _____

P.O. NO.: _____ HP: _____ VOLTAGE: _____ RPM(SYN.): _____ Hz: _____

FRAME SIZE: _____ PRODUCT TYPE: TEFC EQP III SD & 841

COMMENTS: _____

PER: _____ DATE: _____

TAG NO's: _____

| | |
|-------------------------------------|--------------------------|
| <input checked="" type="checkbox"/> | STANDARD (NO AUX. BOXES) |
| <input type="checkbox"/> | RTD AUX. BOX |
| <input type="checkbox"/> | SPACE HEATER AUX. BOX |
| <input type="checkbox"/> | BEARING RTD's |

TOSHIBA RESERVES THE RIGHT TO MAKE CHANGES OF TECHNICAL IMPROVEMENT AND THE DATA MAY CHANGE WITHOUT NOTICE PRELIMINARY

DO NOT USE FOR CONSTRUCTION, INSTALLATION, OR APPLICATION PURPOSES UNLESS THE DRAWING IS MARKED AS CERTIFIED CERTIFIED

TOSHIBA

TOSHIBA INTERNATIONAL CORPORATION

TOTALLY-ENCLOSED FAN-COOLED
HORIZONTAL FOOT-MOUNTED
3 PHASE INDUCTION MOTOR
F1 ASSEMBLY

XT SERIES

VISIT OUR WEBSITE AT:
www.toshiba.com/ind

TYPICAL MOTOR PERFORMANCE DATA

Model: 4003SDSB41B

| | | | | | | | | |
|-----------|-----|------------|--------|--------|----------------|-------------|----------|--------------|
| HP | kW | Pole | FL RPM | Frame | Voltage | Hz | Phase | FL Amps |
| 400 | 298 | 2 | 3580 | B449TS | 460 | 60 | 3 | 435 |
| Enclosure | IP | Ins. Class | S.F. | Duty | NEMA Nom. Eff. | NEMA Design | kVA Code | Ambient (°C) |
| TEFC | 54 | F | 1.15 | CONT | 95.8 | A | | 40 C |

| Load | HP | kW | Amperes | Efficiency (%) | Power Factor (%) |
|--------------|--------|-------|---------|----------------|------------------|
| Full Load | 400.00 | 298.3 | 435 | 96.0 | 89.6 |
| ¾ Load | 300.00 | 223.7 | 332 | 95.2 | 88.7 |
| ½ Load | 200.00 | 149.1 | 235 | 93.3 | 85.1 |
| ¼ Load | 100.00 | 74.6 | 149 | 87.6 | 71.5 |
| No Load | | | 103.3 | | 5.8 |
| Locked Rotor | | | 2974 | | 22.6 |

| Torque | | | | Rotor wk ² Inertia (lb-ft ²) |
|----------------------|-------------------------|--------------------|-----------------------|---|
| Full Load (lb-ft) | Locked Rotor (% FLT) | Pull Up (% FLT) | Break Down (% FLT) | |
| 587 | 155 | 105 | 235 | 147.43 |

| Safe Stall Time(s) | | Sound Pressure dB(A) @ 1M | Bearings* | | Approx. Motor Weight (lbs) |
|--------------------|-----|------------------------------|-----------|--------|-------------------------------|
| Cold | Hot | | DE | NDE | |
| 35 | 15 | 85 | 6313C3 | 6313C3 | |

*Bearings are the only recommended spare part(s).

Motor Options:
Product Family:EQP Global SD
Mounting:Footed,Shaft:TS Shaft

| | |
|-------------|--|
| Customer | |
| Customer PO | |
| Sales Order | |
| Project # | |

Tag:

All characteristics are average expected values.

TOSHIBA INTERNATIONAL CORPORATION · HOUSTON, TEXAS U.S.A.

| | | | | | |
|-------------|-----------|------------------|-------------|-------------|---------------|
| Engineering | SSuryani | Doc. Written By | D. Suarez | Doc.# / Rev | MPCF-1119 / 0 |
| Engr. Date | 4/13/2020 | Doc. Approved By | M. Campbell | Doc. Issued | 6/8/2011 |

SPEED TORQUE/CURRENT CURVE

Model: 4003SDSB41B

| | | | | | | | | |
|-------------------|---|-------------------|------------------|-------------|----------------|-------------|----------|----------------|
| HP | kW | Pole | FL RPM | Frame | Voltage | Hz | Phase | FL Amps |
| 400 | 298 | 2 | 3580 | B449TS | 460 | 60 | 3 | 435 |
| Enclosure | IP | Ins. Class | S.F. | Duty | NEMA Nom. Eff. | NEMA Design | kVA Code | Ambient (°C) |
| TEFC | 54 | F | 1.15 | CONT | 95.8 | A | | 40 C |
| Locked Rotor Amps | Rotor wk ² Inertia (lb-ft ²) | Torque | | | | | | Break Down (%) |
| | | Full Load (lb-ft) | Locked Rotor (%) | Pull Up (%) | | | | |
| 2974 | 147.43 | 587 | 155 | 105 | | | 235 | |

Design Values

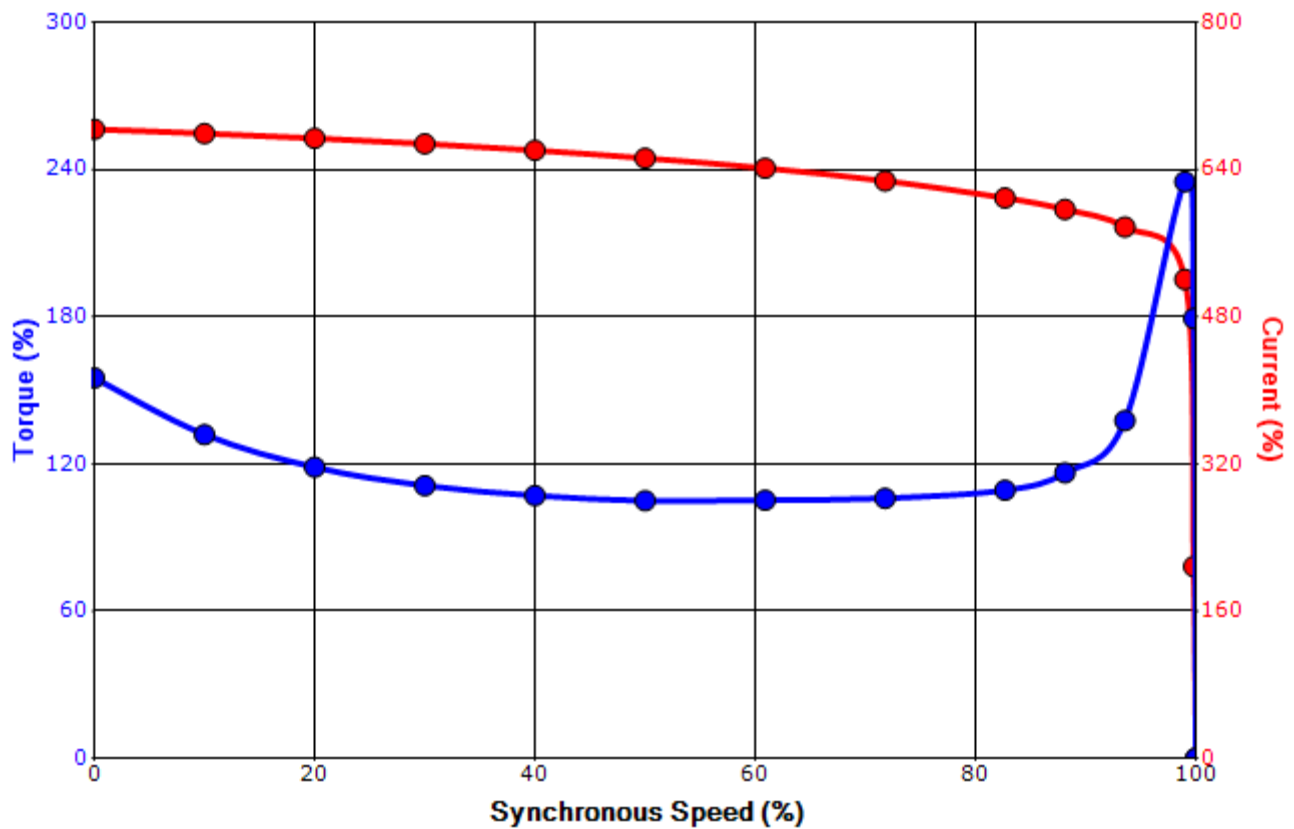

| | | | |
|-------------|--|--|-----|
| Customer | | wk ² Load Inertia (lb-ft ²) | - |
| Customer PO | | Load Type | - |
| Sales Order | | Voltage (%) | 100 |
| Project # | | Accel. Time | - |

Tag:

All characteristics are average expected values.

TOSHIBA INTERNATIONAL CORPORATION · HOUSTON, TEXAS U.S.A.

| | | | | | |
|-------------|-----------|------------------|-------------|-------------|---------------|
| Engineering | SSuryani | Doc. Written By | D. Suarez | Doc.# / Rev | MPCF-1121 / 0 |
| Engr. Date | 4/13/2020 | Doc. Approved By | M. Campbell | Doc. Issued | 6/8/2011 |

Motor Connection Diagrams
6 Leads

Across the Line Starting / Run - Delta:



Alternate Starting Connection - Wye:



Switch L1 and L2 to reverse rotation